



KHV106 0.01 – 6 GHz High Power DC Block

FEATURES

- ❖ High RF Power Handling
- ❖ High DC Voltage
- ❖ Low Insertion Loss
- ❖ Low VSWR
- ❖ Mounting Hole



SPECIFICATIONS

0.01 – 6 GHz High Power DC Block	
Model Number	KHV106
Frequency Range	0.01 – 6 GHz
Insertion Loss	0.2 dB Typ., 0.3 dB Max.
Input VSWR	1.08:1 Typ., 1.15:1 Max.
Output VSWR	1.08:1 Typ., 1.15:1 Max.
RF Power Handling	100 Watt CW Max.
DC Voltage Handling	200 V
Impedance	50Ω Nom.
Connector Type	SMA (other connector type available on request)

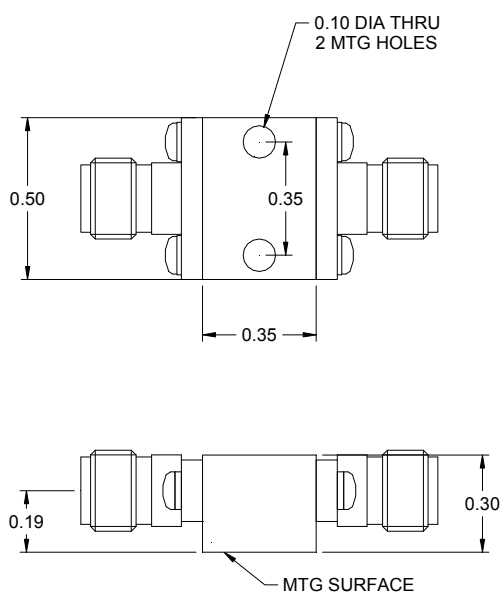

Design to meet the following environmental ratings:
(verification optional)

1. Operating Temp: -55°C to +85°C
2. Storage Temp: -65°C to +125°C
3. Shock: MIL-STD-202F, M213, Cond B
4. Altitude: MIL-STD-202F, M105, Cond B
5. Vibration: MIL-STD-202F, M204, Cond B
6. Thermal Shock: MIL-STD-202F, M107, Cond A
7. Temp. Cycle: MIL-STD-202F, M105C, Cond D

Standard Finishing: Rugged Aluminum Housing.
Optional finishing with blue epoxy paint per MIL-C-22750 available on request, meeting the humidity specification MIL-STD-202F, M103, Cond B

Note:

1. Standard connector is SMA female
2. Part number for different SMA combination is as follow
Add "M" suffix for SMA male to male
Add "MF" suffix for SMA male to female
3. Power handling is tested at 2 GHz