



KHV112 0.01 – 12 GHz High Power DC Block

FEATURES

- ❖ High RF Power Handling
- ❖ High DC Voltage
- ❖ Low Insertion Loss
- ❖ Low VSWR
- ❖ Mounting Hole



SPECIFICATIONS

| 0.01 – 12 GHz High Power DC Block | |
|-----------------------------------|---|
| Model Number | KHV112 |
| Frequency Range | 0.01 – 12 GHz |
| Insertion Loss | 0.30 dB Typ., 0.40 dB Max. |
| Input VSWR | 1.15:1 Typ., 1.22:1 Max. |
| Output VSWR | 1.15:1 Typ., 1.22:1 Max. |
| RF Power Handling | 100 Watt CW Max. |
| DC Voltage Handling | 200 V |
| Impedance | 50Ω Nom. |
| Connector Type | SMA (other connector type available on request) |

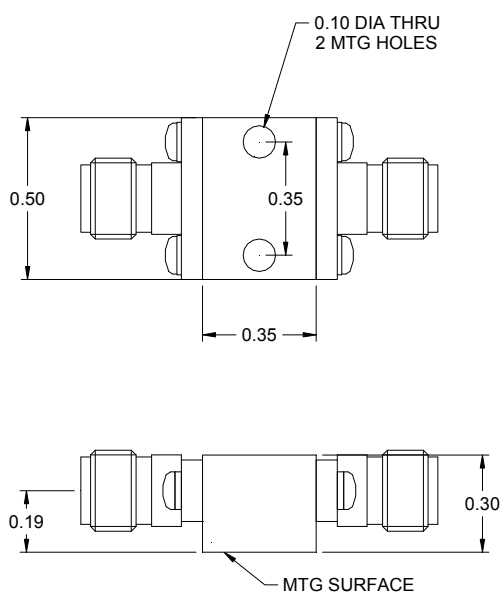

Design to meet the following environmental ratings: (verification optional)

1. Operating Temp: -55°C to +85°C
2. Storage Temp: -65°C to +125°C
3. Shock: MIL-STD-202F, M213, Cond B
4. Altitude: MIL-STD-202F, M105, Cond B
5. Vibration: MIL-STD-202F, M204, Cond B
6. Thermal Shock: MIL-STD-202F, M107, Cond A
7. Temp. Cycle: MIL-STD-202F, M105C, Cond D

Standard Finishing: Rugged Aluminum Housing.
Optional finishing with blue epoxy paint per MIL-C-22750 available on request, meeting the humidity specification MIL-STD-202F, M103, Cond B

Note:

1. Standard connector is SMA female
2. Part number for different SMA combination is as follow
Add "M" suffix for SMA male to male
Add "MF" suffix for SMA male to female
3. Power handling is tested at 2 GHz